



Westmorland
hotel
& conferences



Westmorland
conference venues

business has never had a better outlook
just off the M6 motorway in Cumbria

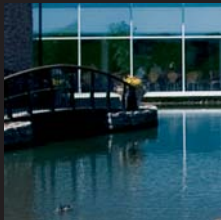

Westmorland
rheged
centre



Westmorland conference venues



meeting rooms - capacities and layouts

the rheged centre

- **State of the Art Auditorium - up to 256 delegates**

Our superb auditorium is available during the day (out of prime holiday periods), and 7 nights a week all year (from 5.00pm). Screen size: 14.4 x 20.4m, (48 x 68ft). Maximum powerpoint presentation size: 7.5 x 12m, (25 x 40ft) through the latest digital projector.

- **The Theatre - up to 220 delegates**

Intimate theatre with tiered seating perfect for large presentations, awards ceremonies, team building, role play and AGMs.

- **The Pennine Gallery - up to 200 delegates**

Two walls of glass provide breathtaking views of the lake, waterfalls, Pennine mountains and Mountain Hall. The room can be divided to offer separate work or refreshment areas.

- **2 purpose built Exhibition Halls**

Ideal for exhibitions, fairs, product launches, indoor team building and conferences. Vehicular access. (See separate insert).

- **The Ullswater Room - up to 70 delegates**

Ideal for larger boardroom style meetings and presentations and has three new picture windows.

- **The Westmorland Room - up to 20 delegates**

Impressive boardroom with secretarial services close at hand.

- **Syndicate Rooms 1, 2 & 3 - up to 20 delegates**

3 Syndicate rooms ideal for meetings and interviews. Can also be used in conjunction with Rheged's larger conference suites. Located adjacent to the exhibition halls making them perfect support rooms for exhibition organisers.

- **Mountain Hall - up to 300 delegates**

At the heart of Rheged is Mountain Hall. A stunning wall of glass overlooks the waterfall and lake and an elevated bar area makes it ideal for drinks receptions, dinners, product launches and parties.

the westmorland hotel

- **The Martindale - up to 75 delegates**

With windows along the length of one wall, the Martindale has spectacular views over mountains and external water features. Ideal for conferences, training and presentations.

- **The Haweswater - up to 40 delegates**

A dedicated conference room with extensive natural light and stunning views. There is a small balcony overlooking the waterfall, an ideal place to refresh.

- **The Conservatory - up to 30 delegates**

A light, open plan room with spectacular moorland views. Perfect for boardroom style meetings or as a training room with its own break out area or refreshment space.

- **Longdale & Ennerdale - up to 15 delegates**

Ideally located as break out rooms for the Martindale or for smaller boardroom style meetings.

- **The Patterdale - up to 6 delegates**

Suitable for small meetings, interviews or as a break out room for the Conservatory and Haweswater.

- All rooms have WiFi broadband connections and air conditioning

- All rooms have WiFi broadband connections, the largest rooms have air conditioning

Visit westmorlandvenues.com for a virtual tour

Westmorland conference venues

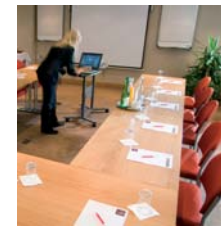

meeting rooms - capacities and layouts

Just call 01768 860011 where a member of our sales team will work with you to establish the most suitable meeting space for your needs. Each venue has a dedicated conference co-ordinator to ensure the smooth running of every event, is within easy access of the M6 and has free parking on site.



THEATRE



CLASSROOM



CABARET

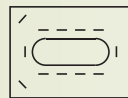

BOARDROOM

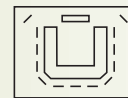

U SHAPE

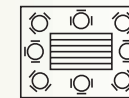

DINNER DANCE

MAXIMUM ROOM CAPACITIES - RHEGED CENTRE								MAXIMUM ROOM CAPACITIES - WESTMORLAND HOTEL					
LAYOUT	Auditorium	Theatre	Pennine	Ullswater	Westmorland	3 Syndicates	Mountain Hall	Martindale	Haweswater	Conservatory	Longdale	Ennerdale	Patterdale
Theatre	256	220	200	70	20	20		75	40	30	15	15	
Classroom			100	50	12			24	18	8	8	8	
Cabaret			100	50				40	20	20			
Boardroom			50	45	15	10		30	22	16	12	12	6
U shape			75	30				24	18	14	10	10	
Dinner			130	70			130	40	20				
Dinner/dance			100				100						
Reception			200				300						
DIMENSIONS (IN METRES)								DIMENSIONS (IN METRES)					
Length	21.5		18.5	13.8	6.12	4.8	22	8	10	11.5	5	5	3.6
Width	21.5		12	6.23	3.76	4.2	10	8	8	5	5	5	3.6
Area m ²	462	14 circular	222	78.69	23.01	20	238	64	80	57.5	25	25	12.96
Height max	14		4	2.3	2.33	2.9	10	3	2.5	2.9	2.5	2.5	2.2
Height min	5		2	2.3	2.33	1.9	8						
Air conditioning	•		•	•	•		•	•	•	•			
Natural light			•	•	•		•	•	•	•	•	•	•
Blackout			•					•	•	•	•	•	•



Westmorland conference venues



exhibition halls (Rheged only) - floor plans and on-site support

exhibition halls

Two purpose built Exhibition Halls (giving a total of 588m², 6335ft²), make Rheged the ideal venue for exhibitions, fairs, product launches, indoor team building and conferences. Vehicular access and an open plan layout allow exhibitors to set up and break down their stands with ease.

Superb location 2 minutes from the M6 (J40) near Penrith; a major crossroads between north, south, east & west and a perfect centre point between the major cities of the Midlands, North of England and Scotland.

2.3



Exhibition Hall 1



Exhibition Hall 2

DIMENSIONS (IN METRES)		
	Hall 1	Hall 2
Length	19.21 max	19.81 max
Width	17.79 max	13.35 max
Area m ²	360.5	228
Height max	4	3.95
Height min	2.3	2.95
Air con		
Natural light	•	•
Blackout		
MAXIMUM CAPACITIES		
	Hall 1	Hall 2
	Call us	Call us

- Superb location just off the M6 (J40), Cumbria
- 450 free car parking spaces
- Use of theatre and auditorium for speakers, demonstrations and audio visual presentations
- Use of two large conference rooms for associated activities
- Marshalling available for vehicles during set up/break down
- Multiple visitor access points
- Excellent disabled facilities
- On-site catering, public cafés, restaurant, specialist shops, payphones, cash machine, bar and 24 hour forecourt
- 588m² of space (Hall 1: 360.5m² Hall 2: 2.228m²)
- Loading Door Dimensions: 2.3m wide x 2.5m high, at ground level allowing vehicular access to Hall 2
- Multiple electric power points
- Halogen lighting
- WiFi / broadband connection available
- 3 adjacent syndicate rooms

Just call 01768 860011 where a member of our team will assist in shaping your exhibition including layouts, signage, visitor flow, set up and break downs, marketing and much more.

exhibition halls - practicalities and floor plans

exhibition halls - floor plan

A simplified plan in electronic format is available for organisers to send to exhibitors / guests.

KEY TO SYMBOLS

-  LIFT
-  TELEPHONE
-  CASH MACHINE
-  DISABLED ACCESS
-  CAFÉ
-  SHOPS
-  LIGHTING CONTROL
-  FIRE EXTINGUISHER
-  FIRE ESCAPE
-  VISITOR ACCESS
-  PILLAR (4 SOCKETS ON EACH)
-  GIANT MOVIE SCREEN
-  THEATRE

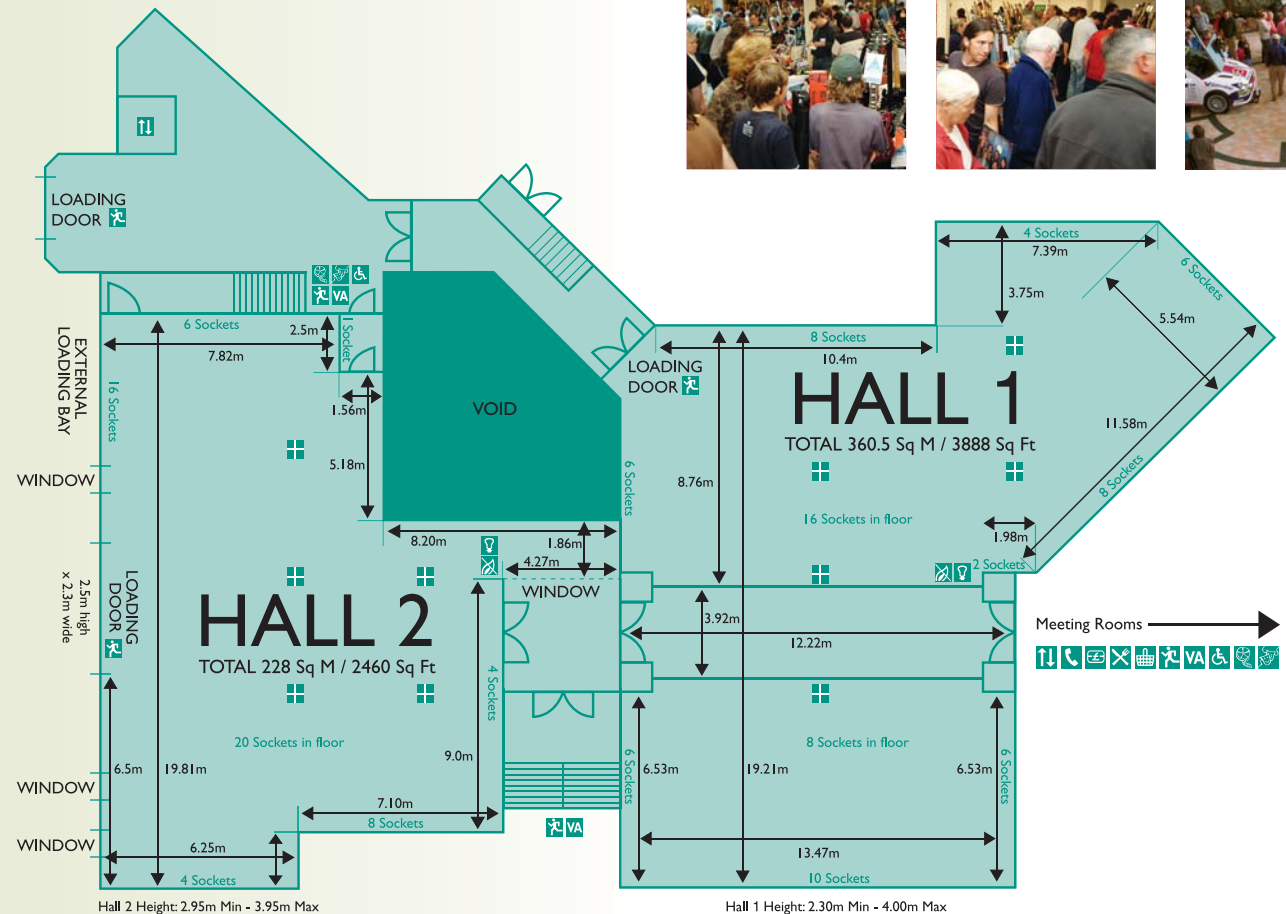

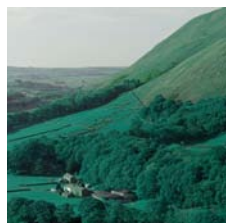
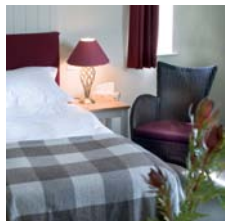

Westmorland

conference venues

delegate packages, business services and equipment hire

day delegate package

From £35.00 per person - for 10 or more delegates

- Hire of Meeting Room
- Welcome tea and coffee with freshly baked petit croissants and pastries from our in house bakery
- Mid morning tea and coffee with homemade biscuits
- Working buffet lunch to include fruit juice, still and sparkling Cumbrian mineral water, freshly brewed Fair Trade tea & coffee, refreshing fruit platter and homemade cakes
- Afternoon tea and coffee with a tempting selection of homemade cakes
- Dedicated on-site Conference Co-ordinator
- Flipchart, pad and pens
- Overhead projector and screen
- Whiteboard and pens
- Stationery kit
- Still and Sparkling Cumbrian mineral water

Rate is based on finger buffets 1, 2 and 3 (see sample menus sheet) and use of all conference rooms excluding the auditorium.

24 hour package

From £127.00 per person - for 10 or more delegates

- Hire of Meeting Room
- Welcome tea and coffee with freshly baked petit croissants and pastries
- Mid morning tea and coffee with homemade biscuits
- Working buffet lunch to include fruit juice, still and sparkling Cumbrian mineral water, freshly brewed Fair Trade tea & coffee, refreshing fruit platter and homemade cakes
- Afternoon tea and coffee with a tempting selection of homemade cakes
- Dedicated on-site Conference Co-ordinator
- Flipchart, pad and pens
- Overhead projector and screen
- Whiteboard and pens
- Stationery kit
- Still and Sparkling Cumbrian mineral water
- Luxurious accommodation in a twin/double bedroom
- Dinner in our award winning restaurant (AA rosette)
- Cooked Cumbrian breakfast with local sausage, bacon & eggs
- Complimentary newspaper

Rate is based on holding your meeting at either one of our venues with overnight accommodation at the Westmorland Hotel.

If you choose to hold your meeting at Rheged, but wish to stay in alternative accommodation, our sales team will be happy to assist, but the package/rate may vary.

A shuttle bus can be arranged to transport delegates between Rheged and the Westmorland Hotel - price on request.

Certain days of the week and months of the year are classed as *off peak* and special rates apply. To take full advantage, contact our sales team on **01768 860011**.

delegate packages, business services and equipment hire

equipment hire

• OHP	£35.00
• Screen	£15.00
• Flip chart	£15.00
• TV & video recorder / DVD player	£55.00
• Video recorder	£30.00
• DVD player	£25.00
• Laptop computer	£150.00
• LCD projector	£80.00
• Carousel and slide projector	£50.00
• Lectern	£50.00
• Microphone & stand	£25.00
• Lapel radio microphone	£45.00
• Radio microphone	£45.00
• Portable CD player	£30.00
• PA system (suitable for 50 people)	£80.00
• PA system (suitable for 150 people)	£150.00
• Interactive white board	£125.00
• Technician (half day)	£150.00
• Technician (full day)	£200.00
• Staging (6ft x 4ft)	£30.00

Prices for flower arrangements, table decorations, signage, transport and additional personnel are available on request.

business services

• Fax	40p per page
• Photocopying	20p per page
• Direct dial telephone	10p per minute
• Email	40p per email sent
• Secretarial Services	Price subject to requirements
• Wireless Broadband	£12 for 8 hours

Certain days of the week and months of the year are classed as *off peak* and special rates apply. To take full advantage, contact our sales team on **01768 860011**.

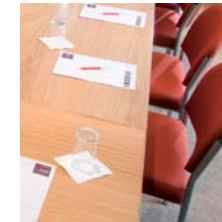
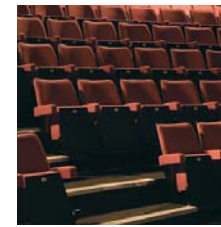



Westmorland

conference venues

evening functions and team building

evening functions

Breathtaking by day, the Rheged Centre truly exceeds all expectations by night. Imaginative lighting is used to emphasise the stunning architecture creating the ultimate atmosphere for evening events. For a more intimate experience, set against a backdrop as old as the hills, there is no better choice than the Westmorland Hotel. Both venues employ teams of dedicated staff ensuring a fantastic event every time.

the rheged centre

- **Themed Evenings**

Within our spectacular Mountain Hall, Rheged has played host to some breathtaking themed evenings such as a Black and White Ball, James Bond, Caribbean, Safari, Halloween, Race Evening, Ladies Pamper Evening and a Boxing Dinner.

- **The Outdoors Indoors**

Rheged is home to the National Mountaineering Exhibition bringing to life the human drama, history and intrigue of the earth's most famous mountains. An inspiring backdrop for a champagne reception, with experts on hand to share amazing stories. Themed drinks and canapés packages available. We can arrange gifts such as books signed by famous mountaineers; Doug Scott or Sir Chris Bonington for example to present to your clients and you can use the exhibition logo on your invites.

- **Bespoke Film Screenings**

In our large format cinema we show seven Giant Movies each lasting 45 minutes. Choose from Shackleton's Antarctic Adventure, Everest, Grand Canyon and Rheged: the Lost Kingdom. Alternatively, you can have exclusive use of our state of the art auditorium to screen a film of your choice.

the westmorland hotel

- **Smaller Events**

For smaller events, the Westmorland Hotel, set in a stunning Cumbrian landscape, provides an intimate atmosphere. With a selection of rooms available the hotel can host anything from a business dinner for 2, to a dinner dance for 120.

- **Accommodation**

The Westmorland Hotel offers 50 spacious en-suite bedrooms.

- **Exclusive Use**

Enhance your event further by making the hotel exclusively yours including our award winning restaurant serving delicious Cumbrian specialities.

- **Entertainment**

Follow dinner with your choice of entertainment - DJ, quiz shows and race nights or for the more adventurous, a comedian or hypnotist!

- **Guest Speakers**

A guest speaker is always a great way to make your event stand out from the rest. There's a wealth of people who provide after dinner entertainment; in Cumbria alone you can choose from Sir Chris Bonington, Lord Melvyn Bragg or broadcaster Eric Robson.

Just call 01768 860011 and a member of our sales team will work with you to tailor everything needed for a truly memorable evening.

evening functions and team building

team building

The Lake District provides an unrivalled environment in which to combine some team building with your conference. Here are just a few ideas.

- **Create! at Rheged**

Delegates can have fun designing their own masterpiece in our Create pottery painting workshop. Ready to take home in 30 minutes and dishwasher safe.

- **Discover Cumbria at Rheged**

A giant 3D map and Exhibition reveals some of Cumbria's most dynamic history; from Ice Age to Stone Age, the arrival of the Romans, construction of Hadrian's Wall and mysteries of the Dark Ages. Lasts approximately 10 minutes. FREE

- **Movie Motivators at Rheged**

Our large format films - each 45 minutes long - have inspiring messages of commitment, leadership, endurance and motivation. Ideal for reinforcing training or team building activities.

- **Indoor Games**

Laser clay shooting, sumo wrestling, boxing kangaroos, a rodeo bull, giant scalextric, table football or bowling alley.

- **Birds of Prey**

Learn about hawk and falcon training techniques and how to handle and fly them safely. Spend the afternoon flying these magnificent birds in open countryside.

- **Mobile Climbing Wall**

Learn to climb with the experts. The wall can be brought to any venue for an afternoon of fun.

- **Country Pursuits**

Book a country pursuits event (at the hotel or off-site) where qualified instructors lead activities such as archery, lawn darts, gun dog or sheep trials, crossbows, croquet and falconry.

- **Paint Balling**

Great for developing team spirit! Why not set up a scenario to increase the adrenaline? Length of play depends on you; we suggest 3 hours minimum.

- **Raft Building**

Where better than the Lakes to build your very own raft and test its capabilities?

- **Canoeing**

Learn the art of canoeing then test your skills on open water.

- **Ghyll Scrambling**

Take a short walk to the top of a Lakeland Ghyll, before being shown the safe method of scrambling descent down waterslides, through pools and over waterfalls.

- **High Ropes Course**

From rope bridges, zip slides and assault courses with stunning views along the way. A challenge for any group.

- **Held at Rheged**

- **Supplied by professional activity companies. Can be held onsite, or within 20 minutes of Rheged or the Westmorland Hotel.**

Just call 01768 860011 where a member of our sales team will be happy to assist in choosing the most appropriate activity for your event.

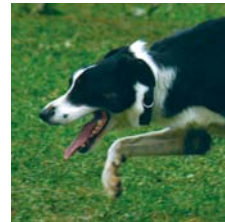
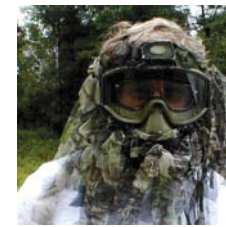

Westmorland
conference venues





sample menus

sample menus

We believe there is no excuse for pedestrian food. Our menus feature only the freshest ingredients, including specially chosen local produce, and are carefully prepared by our dedicated on-site team.

Buffet 1 - Eden

Freshly Prepared Sandwiches and Tortilla Wraps
filled with seasonal local ingredients wherever possible

Hot Cumberland Sausage Rolls
homemade and baked in light puff pastry

Spinach and Sweet Red Pepper Frittata
vegetarian omelette layered with fresh spinach and roasted sweet peppers, served in wedges

Mozzarella, Tomato and Basil Bruschetta
brushed with olive oil, flavoured with a little garlic and served hot

Chicken Liver Pâté served with Oatcakes and Onion Marmalade
smooth and delicious homemade pâté

Buffet 2: Duddon

Freshly Prepared Sandwiches and Tortilla Wraps
filled with seasonal local ingredients wherever possible

Westmorland Lamb Roll
locally reared lamb infused with rosemary and redcurrant, and baked in puff pastry

Chicory and Cous Cous Salad
flavoured with finely sliced sweet peppers and spring onions

Crumbled Wensleydale and Cranberry Toasts
featuring Wensleydale cheese from local Hawes Dairy

Local Trout Pâté served with Horseradish and Biscuits
locally caught trout give a delicate flavour to our homemade pâté

both buffets include

Fruit Juice
Still and sparkling Cumbrian Mineral Water
Freshly Brewed Fair Trade Tea & Coffee

Fruit Platter
a refreshing selection of sliced fruit

Homemade Cakes

Buffet 3: Troutbeck

Freshly Prepared Sandwiches and Tortilla Wraps
filled with seasonal local ingredients wherever possible

Hot Cumberland Sausage Rolls
homemade and baked in light puff pastry

Cumberland Farmhouse Cheese Bake
with cheese from local Thornby Moor Dairies, tomatoes and chives

Homemade Westmorland Beef Pie
local beef with onion chutney in a crisp short crust

Roasted Chicken Wings
tender chicken wings marinated in Tikka spices

Buffet 4: Winster

Freshly Prepared Sandwiches and Tortilla Wraps
filled with seasonal local ingredients wherever possible

Cumberland Cheese Puff Parcels
with tasty farmhouse cheese from local Thornby Moor Dairies

Sweet Chilli Butterfly Prawns
served with sweet chilli Sauce

Cajun Chicken
local chicken fillets marinated in Cajun spices and oven baked

Avocado, Lime and Coriander Mousse with Oatcakes and Biscuits
fresh zesty flavours to revive the most jaded mind

Baked New Potatoes with Rosemary and Sea Salt
served with a blue stilton dressing

both buffets include

Fruit Juice
Still and sparkling Cumbrian Mineral Water
Freshly Brewed Fair Trade Tea & Coffee

Fruit Platter
a refreshing selection of sliced fruit

Homemade Cakes

sample menu selector

Our menus feature only the freshest ingredients including specially chosen local produce; we would be happy to tailor a menu to suit your needs. Extensive wine, champagne and cocktail menus are also available.

Starters

Freshly prepared seasonal soup of the day
with herb crostini

Cream of mushroom and stilton soup
and spiced port foam

Grilled delicé of smoked salmon
on cucumber spaghetti and sweet mustard dressing

Chicken liver and red wine parfait
onion marmalade and dressed leaves

Crown of galia melon and mixed berries
with a seasonal fruit sorbet

Grilled goats cheese and balsamic reduction
with garlic croute and tossed leaves

Terrine of Cumbrian game and poached beetroot
with red onion marmalade

Fillet of Lakeland trout and lime sabayon
with coriander and cous cous salad

Feta cheese, plum tomato and black olive salad
with a green bean and roasted garlic dressing

Galantine of pork and wild mushrooms
with truffle oil and aubergine caviar

Intermediate

Seasonal fruit sorbet

Consommé Celestine
rich beef consommé finished with herb pancakes

Ragout of crayfish tails
with dill and white wine, in a warm puff pastry croute

Main Courses

Shoulder of pork roasted in fennel seeds and sea salt
with apple sauce and roast jus

Grilled fillet steak
with a watercress and pink peppercorn butter

Wellington of salmon and crayfish
with spinach and roasted leek

Roasted topside of beef
with horseradish, Yorkshire pudding and roasted juices

Roast breast of corn-fed chicken
on tarragon, white wine, tomato and mushroom sauce

Leg of our Cumbrian lamb studded with rosemary and garlic
served with a fresh mint and sherry gravy

Twice baked local goats cheese soufflé
with a rocket and parmesan salad

Grilled cutlet of Cumbrian pork
with an apple caramel and basil cream sauce

Wild mushroom and spinach risotto
finished with roasted peppers and garlic oil

Whole baked Lakeland trout
with a lemon, flat parsley and toasted almond butter

Desserts

Apple and cinnamon tart
with crème fraiche

Milk chocolate and Tia Maria ganache
with fresh lime yoghurt

Fresh cream profiteroles
with dark chocolate sauce



Desserts continued

Sachertorte
with a vanilla Chantilly cream

Strawberry meringues
with clotted cream

Sticky toffee pudding
with hot butterscotch sauce

Baked French lemon tart
with a raspberry and orange compote

Sable biscuits
filled with brown sugar toffee apples

Baked vanilla cheesecake
with caramelised oranges and chocolate sauce

Fresh fruit salad
with fresh cream

Freshly brewed Fair Trade tea or coffee
served with a choice of after dinner mints, Cumbrian chocolate truffles or Penrith fudge



Westmorland conference venues



superb location

how to find us

Located close to the geographical centre of Great Britain, the Rheged Centre and the Westmorland Hotel are both very easy to find, located within a 1 - 2 minute drive from the M6 motorway.



How to find the Rheged Centre:

By Road: Just 2 minutes from the M6 (J.40) at Penrith. Rheged is clearly sign posted with brown and white tourism signs from the M6.

By Rail: A 3 minute drive from Penrith Railway Station, which is located on the West Coast Main Line, with regular links to London Euston, Glasgow, Edinburgh, Birmingham, Liverpool, Manchester & Preston. For National Rail Enquiries call 08457 484950.

By Bus: Catch the X4 or X5, a regular service running from Penrith to Keswick. The bus stops at Rheged's main entrance.

By Air: Rheged is less than a 2 hour drive from Manchester Airport.

The Rheged Centre, Redhills, Penrith, Cumbria. CA11 0DQ
Telephone: 01768 868000 • Facsimile: 01768 868002
E-mail: info@westmorlandvenues.com • westmorlandvenues.com

How to find the Westmorland Hotel:

By Road: Just 1 minute from Tebay Services on the M6, between junctions 38 and 39. Accessible from both the north and southbound services by following signs for the hotel after leaving the motorway.

By Rail: A 20 minute drive from both Penrith and Oxenholme Railway Stations, both located on the West Coast Main Line, with regular links to London Euston, Glasgow, Edinburgh, Birmingham, Liverpool, Manchester & Preston. For National Rail Enquiries call 08457 484950.

By Air: The Westmorland Hotel is less than a 2 hour drive from Manchester Airport.

Westmorland Hotel, Near Orton, Penrith, Cumbria. CA10 3SB.
Telephone: 015396 24351 • Facsimile: 015396 24354
E-mail: info@westmorlandvenues.com • westmorlandvenues.com

APPROXIMATE TRAVELLING TIMES

FROM/TO THE RHEGED CENTRE	FROM/TO THE WESTMORLAND HOTEL
Carlisle 20 minutes	Carlisle 40 minutes
Penrith 2 minutes	Penrith 20 minutes
Kendal 40 minutes	Kendal 20 minutes
Newcastle 1½ hours	Newcastle 1½ hours
Manchester 1¼ hours	Manchester 1½ hours
Leeds 1¾ hours	Leeds 1½ hours
Liverpool 2 hours	Liverpool 1½ hours
Edinburgh 2 hours	Edinburgh 2½ hours
Glasgow 2 hours	Glasgow 2½ hours



The Rheged Centre and the Westmorland Hotel have access and facilities for the less able. Rheged has shopmobility scooters available to hire (please book in advance).

This page has been designed so you can fax it to your delegates.

we are a small family business • home grown • down to earth • farmers • in love with Cumbria • protective of our environment • keen to promote local talent • proud of our homemade food • passionate about quality • honest • approachable • individual • loyal to our customers • always striving to be the very best in everything we undertake

